

Principal: Mr. A. Chan

School Trustee Liaison: Mr. David Yang

2022-2023 School Year

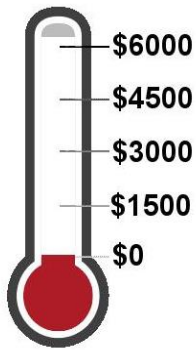

15th Annual Prowl-A-Thon – Request for Contributions

Dear Lee Families,

Our 15th Annual Lee Lion Prowl-A-Thon is back! The Prowl-A-Thon is a walk-a-thon with a Lee Lion twist. The event is organized by the Parent Advisory Council (PAC) and will be held **Friday, May 5th, 2023**. This year's event theme is "**Shine Bright Lee Lions**".

The Lee PAC is excited to organize this fundraising event that celebrates our school community and spirit in a bright, unique and healthy way. **All funds raised go directly to supporting our students.** The Lee PAC ensures that the children at our school enjoy an enriched and meaningful education. Through our Hot Lunch program and many other strong initiatives like this event, we have provided essential funding for field trips, classroom supplies, leadership activities and classroom teacher wish list items. All of these activities are in place to produce a better student and person for our community.

Students, staff, and families are invited to **show their spirit by dressing in their Brightest Colours on May 5th, 2023** and come out to run, jog, walk or otherwise "prowl" around our school track.

As part of our "**Shine Bright Lee Lions**" festivities, we will be holding a **prize draw**. Make a contribution to this campaign by **May 4th, 2023**, and your child's name will be entered in this draw. Wonderful prizes have been generously donated to our event by local businesses including **Cineplex, Lucky 9 Lanes Bowling, West Coast Mini Putt & Subway Restaurants**. Thank you to all our community sponsors for their support!

We will also be offering a **Bonus Prize Incentive of 2 CLASS PIZZA PARTIES**. The first one will be awarded to the class which raises the most money. The second will be awarded to the class which has the highest percentage of students make an individual donation. Make sure to add "PAC Donation" and your child/children's name(s) and division(s) when you donate online, to be counted towards this prize.

Contributions to the PAC will be collected **online only** this year through the Richmond School District website, <https://sd38.bc.ca/our-district/donations> or [Click here](#). Please see the following page for detailed instructions on how to donate.

The PAC welcomes and encourages all parents to get involved in whatever way you can throughout the school year. For those parents who are unable to volunteer their time, a financial contribution is a great way to support our school. Your contribution will help create the best possible learning environment and experience for all students. If you have any questions about this campaign or how to get involved in the PAC, please email us at LeeElementaryPAC@gmail.com.

Thank you for supporting your children, Walter Lee Elementary, and the PAC!

Instruction for Making Donations Online

Please go to the Richmond School District website @ <https://www.sd38.bc.ca/>, then follow the steps below.

Step 1 When you are on the home page

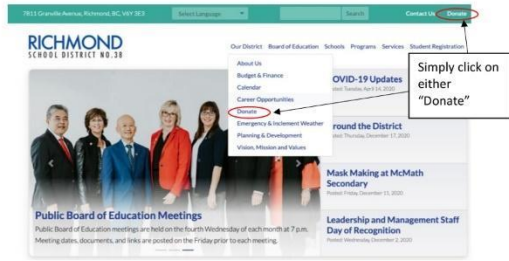

Step 2 When you see the below page, please click

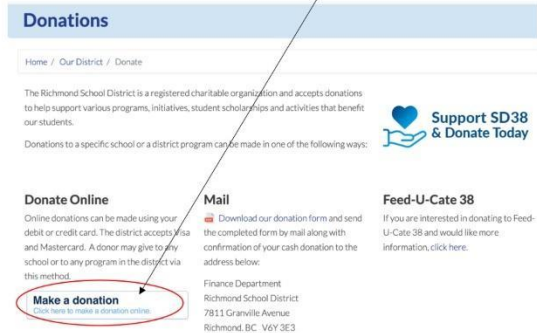

Step 3 Choose or enter the amount of your donation and select "Lee Elementary"

How to donate online P. 1

How to contribute online: Please follow the instructions provided on this page to make your contribution.

Step 1: Go to <https://sd38.bc.ca/our-district/donations>

Step 2: On the Donations page, click on "Make a donation" under Donate Online.

Step 3: Complete the details for your donation.

- Enter the amount of your donation.
- Select "Lee Elementary" as the *Fund Destination* to ensure that your donation is received by our school.
- In the *Message to School Board* box, enter "PAC Donation" and your child/children's name(s) and division(s).
- Click "Add to Cart".

Step 4: You will be redirected to the **SchoolCashOnline** cart. Please check that your donation amount is correct and that "Lee Elementary" is specified. Edit if changes are required or click "Continue" when you are ready.

Step 5: Log in to your **SchoolCashOnline** account to complete payment. Payment may be provided by credit card (VISA/Mas

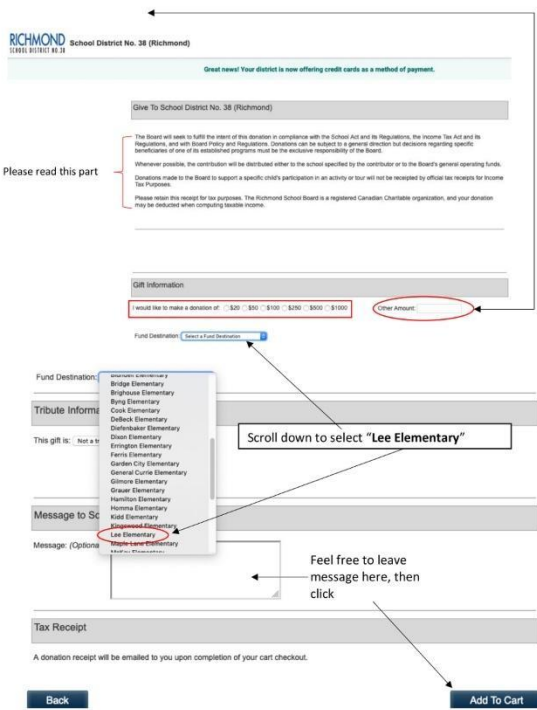

Step 4 Edit the amount if needed, please make sure it's for Lee Elementary

How to donate online P. 2

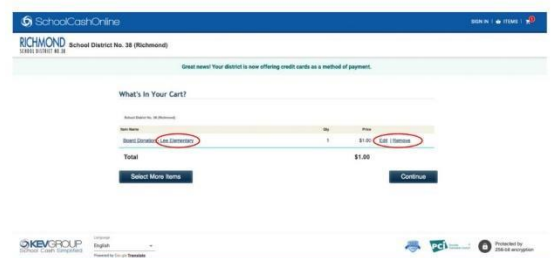

Step 5 Log into your account (the same one used for paying school fees)

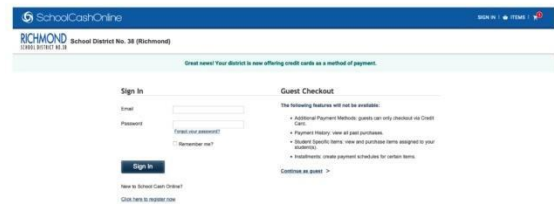

Step 6 Select one of methods and click "Continue" to complete your donation



How to donate online P. 3